

# ZR24Y

## Technical data

Type	Ratio i	2800 n2 (min1)		1400 n2 (min1)		900 n2 (min1)		700 n2 (min1)		RD	Kg
		M2 [Nm]	P1 (kW)	M2 [Nm]	P1 (kW)	M2 [Nm]	P1 (kW)	M2 [Nm]	P1 (kW)		
ZR24Y	1	26.0	7.9	29.0	4.4	32.0	3.1	25.6	2.5	0.97	5.0
	2	29.0	4.4	32.0	2.4	35.0	1.7	35.0	1.2	0.97	

## Dimensions

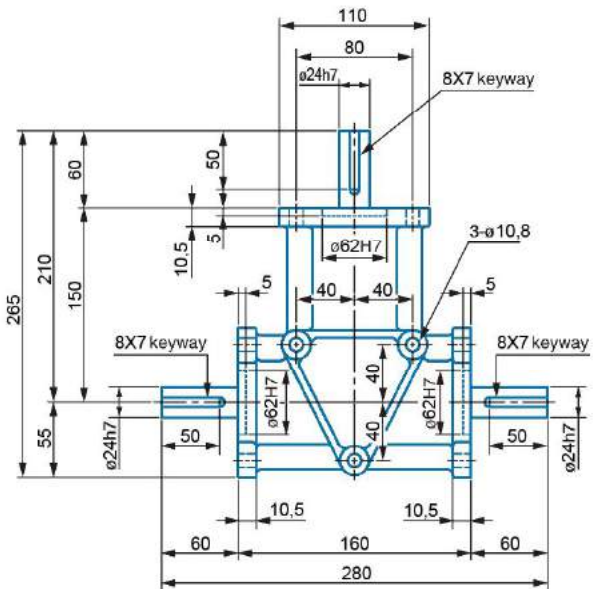

ZR 24Y T

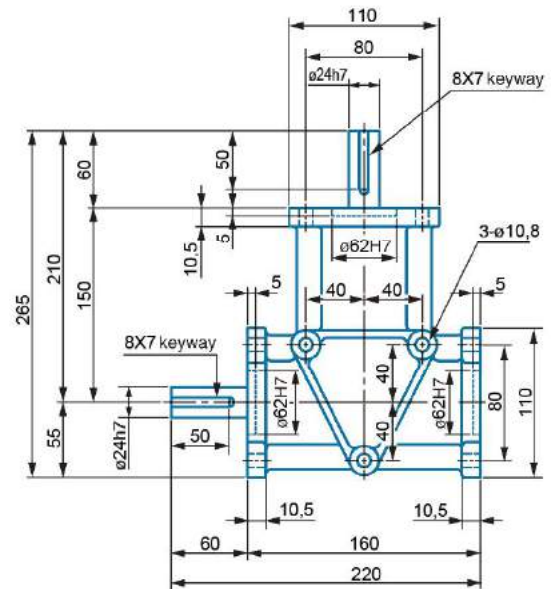
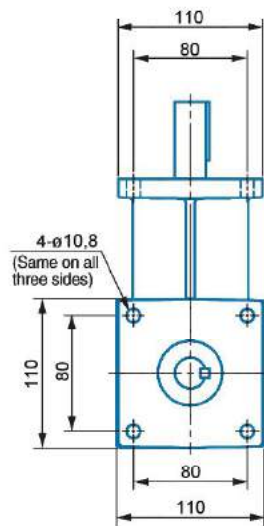

ZR 24Y LA/LB

## Shafts position and direction of rotation

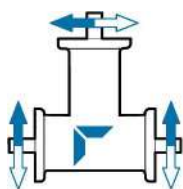

T

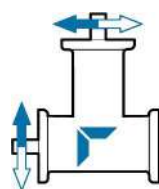

LA

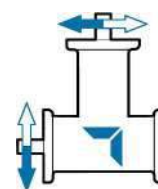

LB